

REV	DESCRIPTION	DATE
0	ISSUE	08/13/06
1	Add Label	07/29/08
2	Rev Hood Mold	08/27/12

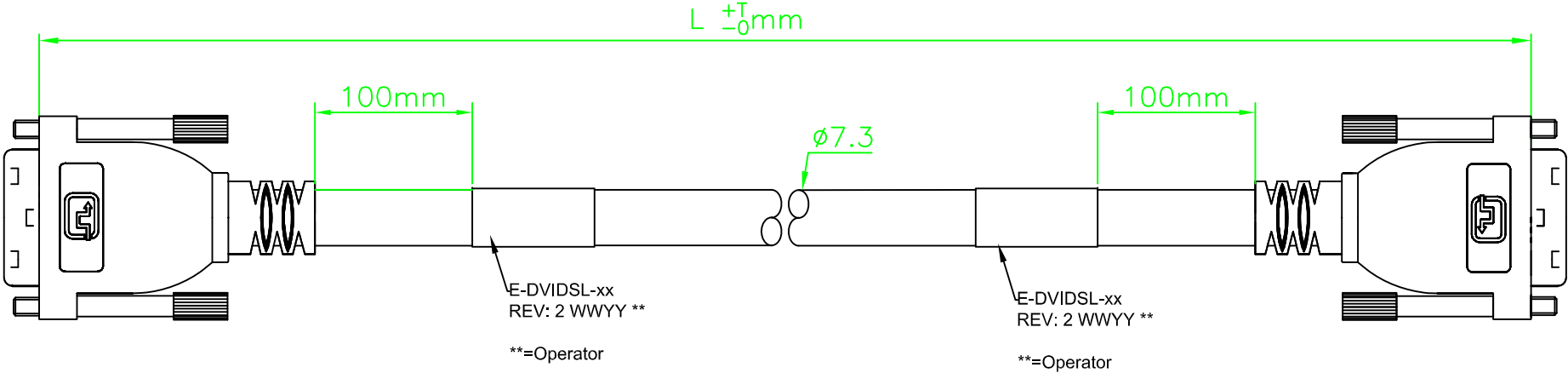

Notes:  
 Regulatory compliance details  
 NEC CL2 75°C  
 CEC CSA I/II A/B AWM FT4 150V 80°C  
 EU ROHS 2002/95/EC Compliant

E-DVIDSL-10	10000	100
E-DVIDSL-8	8000	78
E-DVIDSL-6	6000	78
E-DVIDSL-4	4000	50
E-DVIDSL-2	2000	30
E-DVIDSL-1	1000	20
P/N.	L(mm)	T(mm)

LIBERTY AV SOLUTIONS  
 11675 RIDGELINE DRIVE  
 COLORADO SPRINGS, CO 80921

WWW.LIBAV.COM  
 (800) 530-8998

UNIT: mm	TITLE:
SCALE: None	Assembly Specification CBL, ASY, DVI
UNLESS OTHERWISE SPECIFIED TOLERANCES: x ±.015 xx ±.010 xxx ±.005 ANGLE ± 1°	PART NUMBER: E-DVIDSL-XX
	DR. RP
SHEET 1/2	DWG. #: LWC-ASY-00010
	CH. RP
	AP. RP

REV	DESCRIPTION	DATE
0	ISSUE	08/13/06
1	Add Label	07/29/08
2	Rev Hood Mold	08/27/12

PIN OUT  
DVI(18+1)M ——— DVI(18+1)M

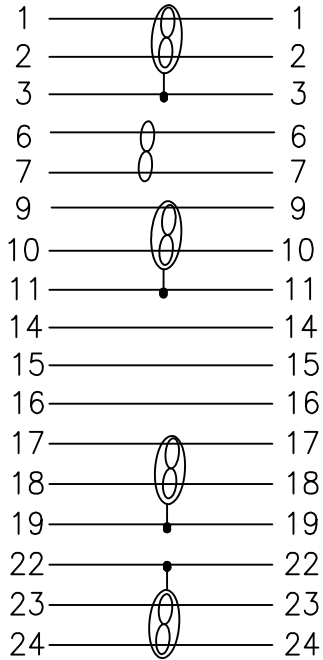

SHELL — BRAID&DRAIN — SHELL

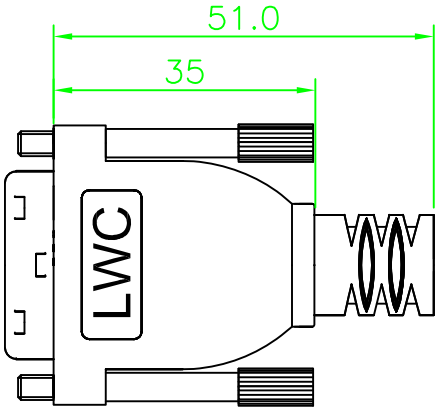
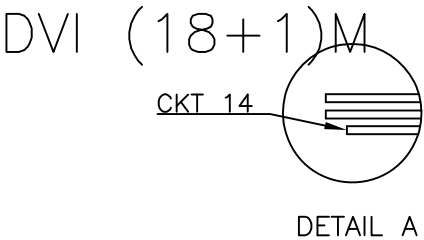
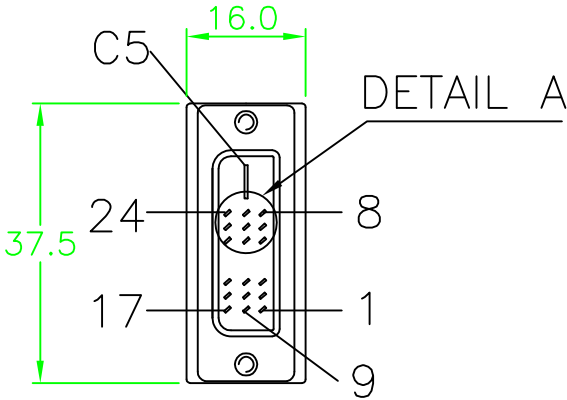

LIBERTY AV SOLUTIONS WWW.LIBAV.COM  
11675 RIDGELINE DRIVE (800) 530-8998  
COLORADO SPRINGS, CO 80921

	UNIT:mm	TITLE: Assembly Specification CBL, ASY, DVI	
SCALE	None		
UNLESS OTHERWISE SPECIFIED TOLERANCES: x ±.015 xx ±.010 xxx ±.005 ANGLE ± 1°	PART NUMBER:	DR.	RP
	E-DVIDSL-XX	CH.	RP
SHEET 2/2	DWG. #:	AP.	RP
	LWC-ASY-00010		